

Industrial Grade Satellite Tracker Installation

- ClearPathGPS **highly** recommends using mounting hardware made from a higher-grade series stainless steel. Other mounting hardware material types may be subject to shortened life due to corrosion.
- Ensure **all** mounting hardware is compatible with the asset.
- Ensure **all** regulatory compliance and asset owner policies and procedures are adhered to during installation.
- When using stainless steel mounting hardware, it is **highly** recommended to use a marine grade anti-seize material on the bolt threads as galling and seizing of stainless nuts and stainless bolts may occur.
- Using smaller bolt sizes (5/16" or 8mm) is possible but not recommended since they will not provide equivalent mounting strength.
- To avoid staining and discoloration, zinc coated mounting hardware should not be used with the metal bezel.
- Failure to follow mounting and installation instructions accordingly may result in damage to the device or asset and persons or property. ClearPathGPS is not liable for damages or injuries caused by improper installation.

Step 1: Selecting a Mounting Location

To ensure ideal performance it is advised to consider the following:

- Select a mounting location that provides the best view of the sky.
- A flat horizontal mounting position (lying flat, facing skyward) is preferred.
- Vertical mounting orientations (printed face of device facing horizon) are acceptable but may impact performance and overall battery life.
- Mount on the flattest and hardest surface possible.
- Select a mounting location that isolates the GTO from damage.
- Recommended mounting area size is 5.0"L x 3.5"W (130mmL x 90mmW).
- Thoroughly clean the mounting area, especially if using VHB mounting.
- **DO NOT PAINT OR COVER THE GTO.** Doing so may negatively impact product performance and battery life.

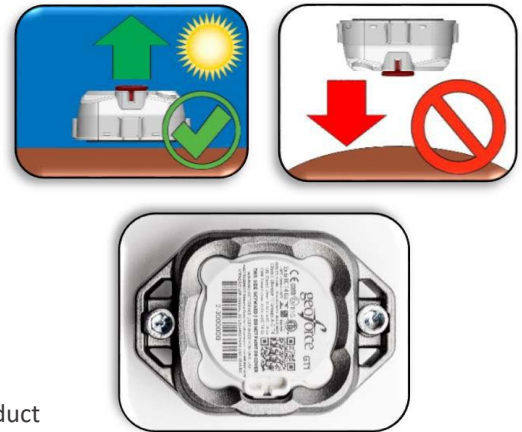

Step 2: Selecting a Mounting Method

Mechanical Mounting (Recommended)

- All mounting hardware recommendations can be found at www.mcmaster.com
- **Socket-Head Cap Screws (3/8" bolt diameter)** - For installations that can be drilled and tapped and do not have access to the back side of the mounting surface.
 - Option 1 - Less Harsh Environments / Part Number: 96006A922
 - Description: Black Oxide 18-8 Stainless Steel Socket Head Cap Screw 3/8"-16 Thread, 1-1/2" Length
 - Option 2 – More Harsh Environments / Part Number: 92185A677
 - Description: Type 316 Stainless Steel Socket Head Cap Screw 3/8"-24 Thread, 1-1/2" Length
- **Hex-Head Cap Screws (3/8" bolt diameter)** - For installations that have access to the back side of the mounting surface for securing a nut or bolt use
 - Option 1 – Less Harsh Environments / Part Number: 92198A628
 - Description: 18-8 Stainless Steel Hex Head Cap Screw 3/8"-16 Thread, 1-1/2" Length
 - Option 2 – More Harsh Environments / Part Number: 93190A367
 - Description: Type 316 Stainless Steel Hex Head Cap Screw 3/8"-24 Thread, 1-1/2" Length

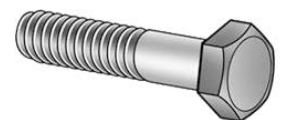

- **Self-drilling Sheet-metal Screws (1/4" diameter)** For installations with thinner mounting surfaces where a quicker less robust install is needed. Be sure to clean out all drill shavings!
 - Part Number: 90822A630
 - Desc.: Stainless Steel Drilling Screw for Metal, High-Strength, 1/4"-14 Thread, 1-1/2" Long



Ultra-Rugged Mounting

- Requires Stainless Steel Bezel and Weld-Down/Adapter Plate Accessory
 - Please contact ClearPathGPS if interested in this add-on.
- This applies to installations where resistance to extreme environments is required or where a welded down and prepared 'GTO ready' surface for the device is preferred.
- Refer to the GTO weld-down plate installation guide for more information. (Available upon request)



VHB Adhesive Mounting

- For installations that **do not require** a protective bezel (isolated from abuse, extreme weather, and temperatures) the GTO has a preinstalled pad of VHB adhesive tape that can be used to "peel and stick" to any clean surface above 50F (10C).
- The VHB Installation and Removal Guide **MUST** be followed to ensure proper adhesion to the asset. Available upon request.
- **Using only the VHB Adhesive for mounting is not permissible when the protective bezel is installed. Protective bezels must be bolted or screw mounted to avoid serious injury/damage.**



Step 3: Assign to the Asset

- Record the GTO serial number _____
- Complete our "Text-To-Activate" process to name the device according to which asset it was installed on. The number before the dash must be included (e.g. 2-3000000)
 - Send an SMS text message of the GTO serial number to **(805) 695 2388** to complete the Text-To-Activate process.
 - Alternatively, you can name and update information about the asset that the device is installed on in the web portal under "Vehicle Admin"



Step 4: Initialize the Device

- To finish activating the device and begin GPS reporting, remove the magnet using the pull tab while outdoors with a good sky view. Removing the magnet indoors may lead the GTO to enter Power Save Mode.
- **WARNING: IF YOU DO NOT REMOVE THE MAGNET THE GTO WILL NOT WORK!**
- Installation is complete.



If you have any questions or need assistance, call us at **(805) 979 3442 Option 2** for support.

- Phone lines are open 7:30am - 5:30pm (PST) Monday through Friday.
- Please leave a detailed voicemail if outside of the above hours, including company name and relevant device numbers if possible. We will follow up with you as soon as possible.
- You can also email support@clearpathgps.com with questions or concerns.