

AIR II: Conventional Hardwire

Before You Begin

Note: The AIR II device ships with many installation components; not all components are required for each install. Please refer to the guide for details on which components are recommended.

The installation kit contains a registration card, the AIR II device, a device dock, a mount plate with adhesive, a hardwire power harness, a memory SD card (not shown below), and hardwire accessories (two fuse holders, two heat-shrink butt connectors, one ring terminal, one star washer, and one ground screw).

Note: The SD Card will be pre-installed in the camera for T-Mobile shipments.



Note: If you are not familiar with testing and installing power system-related items, professional installation assistance by a qualified installation vendor or dealer is recommended.

Installation Overview

The following steps provide an overview of the installation process:

1. Device Connections.
2. Device Mounting.
3. Adjust Angle.
4. Verify Installation.

Installation Steps

1. Device Connections

1. With keys removed from the ignition, locate a vehicle wire providing 12 to 14 VDC (+). This will be the constant power wire power source.
2. Complete the following steps to poke and wrap the connection:

Note: Manufacturer-supplied hardwire accessories which include fuse taps MAY BE included in your order. Do NOT use these fuse taps. Instead, follow the poke-and-wrap guidelines below.

- a. Prep the power harness by cutting the existing connections and adding supplied in-line fuse holders to constant (red) and ignition (white) wires and add ring terminal to ground (black) wire.
- b. Remove 1 in. (2.5 cm) of insulation from the vehicle wire identified, poke something non-conductive between the wire strands creating a loop and insert the harness Red wire.
- c. Squeeze the loop shut, tightly wrap the bare wire around the exposed wire at least three times and fold the wire over the connection.
- d. Generously wrap electrical tape around the connection, crossing over the insulation on both sides.
- e. Secure the connection with one cable tie directly over the wire-to-wire connection and another creating a stress loop created about 1 in. (2.5 cm) away from the connection.

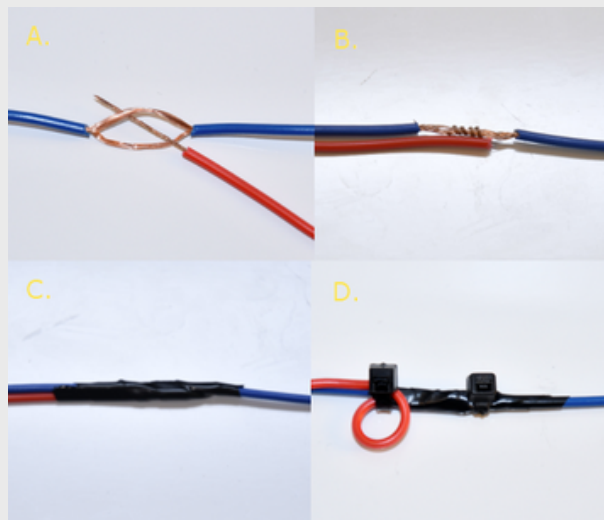

3. Locate a vehicle wire which provides at least 12 VDC (+) and 14 VDC (+) while the vehicle is On and running and 0 VDC (+) when the key is in the Off and Accessory position; this will be the 6-Pin Harness White wire power source.

- a. Repeat Step 2.2: A-E to make the same type of wire-to-wire connection for the Switch/White wire.
- b. Locate a suitable location on the chassis to attach the device Black/Ground wire. Confirm there is nothing behind the mounting location and screw the ring terminal to the chassis.



4. Route the wire with USB Type-C plug of the Power Cord to the expected camera mounting location on the windshield.

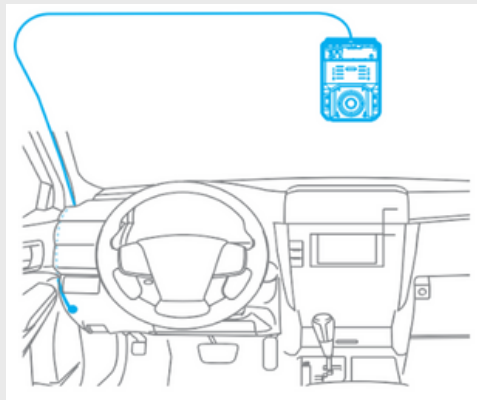

Note: Leave an extra few inches of cord length near the camera to insert the Type-C plug into the AIR II Dock, and also make mounting and dismounting the camera easier.



5. Secure any excess wire after the camera is mounted.

2. Device Mounting

1. With the Mount Plate attached to the windshield and the power cord connected to the AIR II, position the AIR II on the right side of the Mount Plate. Next, ensure the Mount Plate locking tabs are aligned with their fittings on the camera dock.

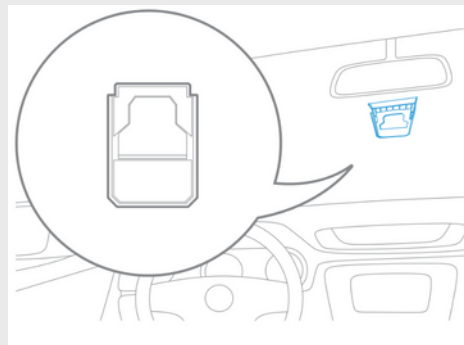

Important: Ensure you are using the most appropriate mount based on the curve of the windshield. Available mount options shown below.

2. Slide the camera left and down to secure it firmly onto the Mount Plate.

Note: Ensure the AIR II is installed properly and firmly attached to the windshield before operating the vehicle. Be sure to make any adjustments to the angle or position of the AIR II before operating the vehicle.

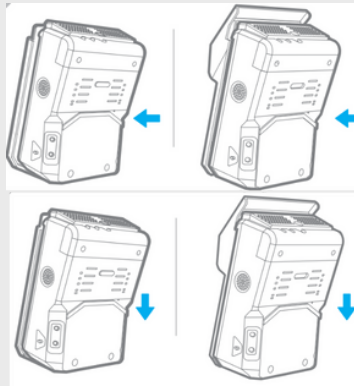

3. Adjust Angle

1. Use a coin to loosen the Dock hinge by turning the adjustment slot counter-clockwise.
2. For optimal vision in and around your vehicle, adjust the camera's position to make the Dock hinge parallel with the road.
3. Tighten the Dock into place by turning the adjustment slot clockwise with a coin.

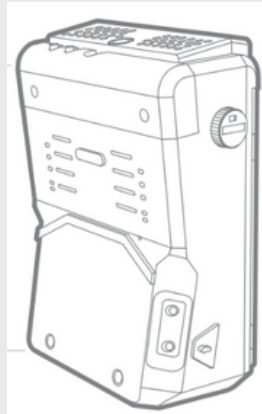

4. Verify Installation

After the device is installed in the vehicle, the vehicle information must be added to the ClearPath GPS Portal.

- If you have portal access, you can log in and enter the vehicle details directly in the app. Step-by-step instructions for adding a new vehicle and device are available here:
- <https://support.clearpathgps.com/hc/en-us/articles/360057428992-Vehicles>
- If you are an installer or do not have portal access, please contact ClearPath Support at (805) 979-3442 with the device serial number and vehicle details, and they will complete the setup for you.

LED Mode/Button Overview

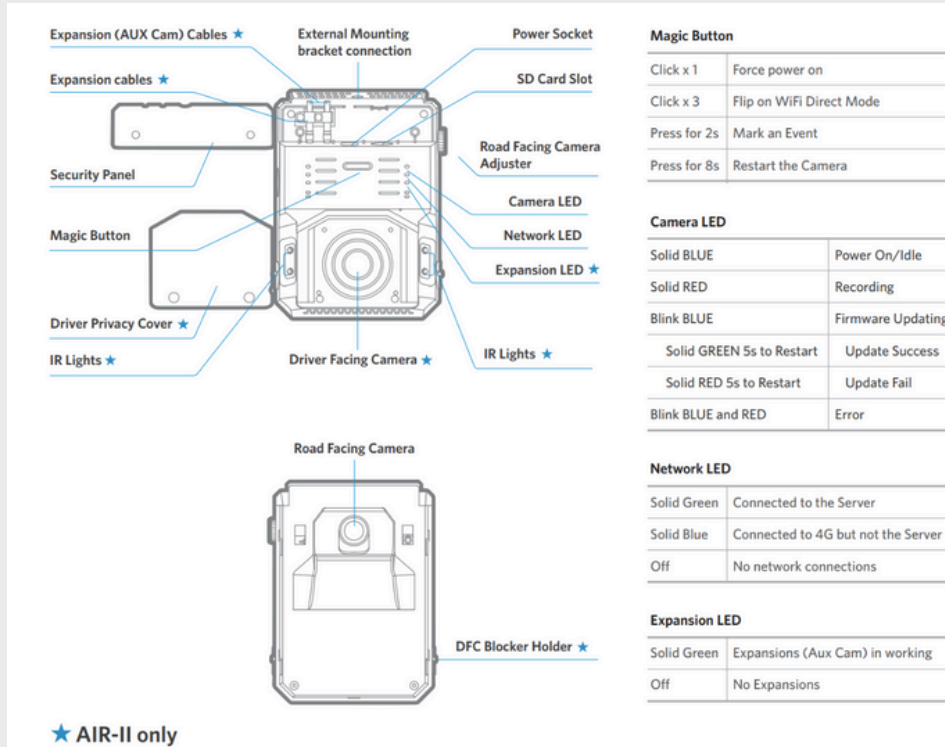

Adjust Driver-Facing Camera

The Driver-Facing Camera's pitch and yaw can be adjusted directly.

1. Remove the Driver Privacy Cover, using finger directly adjust the Driver-Facing Camera. Adjust the camera angle so that its horizontally parallel to the vehicle cabin.



2. Use the Verify Installation steps to verify camera orientation.
3. If applicable, insert the Driver Privacy Cover top edge into the slot, press it into place, and then secure it with screws provided.

